SECRET BEACH

West Bay, Cayman Islands

PROPERTY DETAILS

Price: CI\$2,689,600	MLS#: 420815	Type: Residential
Listing Type: Condominium	Status: Current	Bedrooms: 2
Bathrooms: 2.5	Built: 2027	
Sq. Ft.: 1685.5		

PROPERTY DESCRIPTION

An extraordinary enclave with features and materials previously unseen in Cayman. You'll experience an island, on an island at Secret Beach. Positioned directly on the oceanfront, on a rustic sandy beach 10 minutes from the hotels. The buildings will be clad entirely in beautiful Spanish limestone, creating a timeless and sophisticated architectural core. Expansive 10 foot floor-to-ceiling glass systems, similar to those featured in Miami Beach's iconic Five Park development, maximize natural light and frame breathtaking turquoise reef views. Each designer-ready residence features: • Custom Italian Aster Cuccina Cabinetry and shelving • Lualdi natural oak interior doors with recessed bronze aluminum frames • Lualdi luxury shower enclosures • Premium porcelain stone, glass, and architectural finishes • Large-format 4' x 4' and 4' x 8' porcelain flooring with elegant natural textures in muted grey and sand tones • 10-foot ceilings creating spacious, light-filled interiors At the heart of the development is an incredible 90-foot-wide infinity pool stretching nearly 30 feet across the oceanfront deck, seamlessly blending into the turquoise waters beyond. It is a true infinity-over-the-sea experience and one of the most impressive residential pools in the region. Behind the pool, owners will enjoy access to a 1,700-square-foot oceanfront Owners Lounge, complete with bar and 2 lounge areas designed for entertaining, relaxing, or simply enjoying the spectacular views and watching the children play in the pool from the comfort of air-conditioning. Wellness amenities include a state-of-the-art fitness concept featuring a salt sauna, traditional hot hammam, and invigorating ice shower. This development offers a level of finish and service rarely found in private residences, including: • Secure gated beachfront community and sandy beach access • 24-hour security • In-house management and butler services • Concierge-style assistance • Three dedicated house v... [View More](#)

PROPERTY FEATURES

Views	Beach View, Pool View
Block	1C
Parcel	277H9
Floor Level	3
Sea Frontage	90FT

PRESENTED BY



Bettina Baldwin
+1-345-916-7766
bettina@paradisepropertiescayman.com







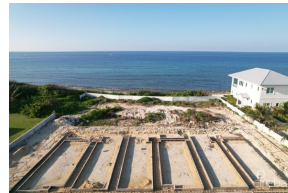
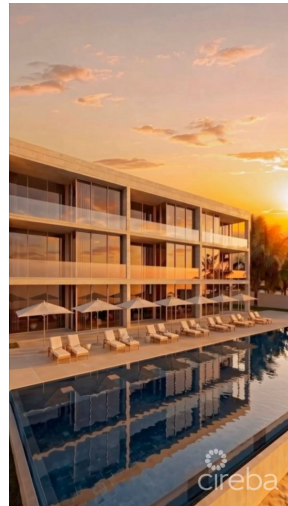



VILLA TYPE A

- 2 bedrooms
- 2.5 baths
- 1 office/study
- 1,686 sq. ft.

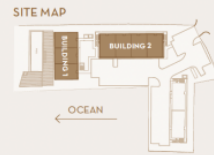

aireba



aireba

VILLA TYPE B

- 2 bedrooms
- 2.5 baths
- 1 office/study
- 1,661 sq. ft.



aireba

VILLA TYPE C

- 2 bedrooms
- 1 office/study
- 2.5 baths
- 1,661 sq. ft.

BUILDING 2 Villa 12, Villa 17, Villa 20



SITE MAP



DESIGN VISION



The interiors of Secret Beach Residences embody the refined elegance of modern coastal design, merging clean architectural lines with soft natural palettes inspired by Cayman's shoreline. Every finish has been curated to create a seamless transition between the interior and the ocean beyond, reflecting understated sophistication and contemporary island living.



MOOD BOARD



FLOORING & HARD SURFACES

Selection: Large-format porcelain tiles flow continuously throughout the residence and extend onto the private terrace, creating a cohesive visual connection between indoor and outdoor spaces.

Material: Porcelain, 28" x 56" format

Finish: Matte, anti-slip for terrace

Color: Sedimenti White – a subtle stone-inspired tone providing light, texture, and timeless elegance.



KITCHEN DESIGN

Salina – a soft mineral grey with subtle veining

Vigil – a dramatic charcoal stone aesthetic

Appliances: Fully integrated Miele suite – induction cooktop, oven, hood fan, microwave/speed oven, French door refrigerator, and dishwasher panelled to match cabinetry.

Laundry: LG stacked washer/dryer and stainless sink with single-lever mixer.



Vigil



BATHROOMS

Walls & Floors: Porcelain tile – color to coordinate with kitchen selections (Salina or Vigil). Anti-slip shower floors.

Mirrors: Backlit rectangular LED mirrors for soft, flattering illumination.

Toilets: Kohler vacuum-flush (Model K-3493-T) with "Brevia" soft-close seat.

Bathtubs: Undermount acrylic tubs finished with porcelain tile deck surround.

Accessories: Chrome towel bars, TP holders, and modern rectangular shower handles.



Vigil





(SB) DOORS & HARDWARE

Interior Doors: Italian Lualdi series – Filo 55s or Rasoline 55s – featuring concealed hinges and flush minimalist profiles.

Finish: Natural – Oak

Hardware: Chrome, hidden hinge system.

Handles (Options): Lualdi / Outline / Ishi

Baseboards: 4 1/2" flat-profile wood, primed and painted to match wall finish.



(SB) CABINETRY (ASTER CUCINI)

Locations: Kitchen (Upper cabinets – tinted glass), bedroom closets, bathroom vanities and laundry rooms, with soft close hardware.



(SB) PLUMBING



Bathroom Vanity Faucet:
All fixtures throughout to be of the Italian "Zucchetti" brand or equivalent, in a Chrome finish (Subject to change pending location)
Bathroom Vanity Faucet:

Kitchen/Laundry:
(Subject to Change – Equal to or better)
Single Lever Mixer with swivel spout and pull-out spray
Kitchen: 50/50 Undermount Basin
Laundry: Stainless Sink

Model: Octo.



(SB) SHOWER GLASS



Shower: Clear Glass with chrome accessories (Subject to change)

Optional Upgrade
Lualdi floor to ceiling glass enclosure with tint glass



(SB) BATHROOM HARDWARE/ACCESSORIES

Mirrors: Rectangular LED Backlit mirrors in bathrooms.



Bathtub: Undermount Tub with a hard surface
Tile for finish on top.

Type: Acrylic

Style: Undermount

Color: White

(SB) LIGHTING & ELECTRICAL





Lighting Concept: Discreet and functional lighting complements the clean architectural language of the interiors.

Ceiling Fixtures: 4" ultra-slim recessed LED downlights

Ceiling Fans: Topan Smart 52" in matte white finish

Switches & Receptacles: Decora White Series



Decora Switches/Receptacles (WHITE)

(SB) APPLIANCES:

Miele or equivalent

- Induction Cooktop, Oven, Hood Fan, Microwave/Speed oven.
- French Door Fridge and Dishwasher to be panel ready to match cabinets.
- LG stacked washer/dryer.

