

## ONE|GT RESIDENCES - UNIT 902

George Town, Cayman Islands

### PROPERTY DETAILS

Price: CI\$4,290,000	MLS#: 414270	Type: Residential
Listing Type: Condominium	Status: Current	Bedrooms: 4
Bathrooms: 4.5	Built: 2026	
Sq. Ft.: 3490		

### PROPERTY DESCRIPTION

Cayman's next landmark development project, known as ONE|GT, fuses the very best of contemporary urban living from around the world - from the vibrant rooftop beach clubs of Miami and LA, to the local piazzas and street cafés of Europe, and of course exquisite Caribbean artistic flair. Comprising a 178-suite boutique hotel and luxury residences, with amazing on-site amenities, ONE|GT is located at the edge of central George Town, on Goring Avenue, directly behind Bayshore Mall. With amazing on-site amenities, ONE|GT will be the capital's first ten-storey structure, rising to 144' above ground level and offering spectacular multi-aspect views. Its eleventh floor "Sky Club" with its unique infinity edge pool, private cabanas, bar & grille, yoga, treatment, and event areas, will bring a new level of sophisticated enjoyment to our islands, whilst its "signature" restaurant, grand café, and many other amenities will ensure owners, tenants and guests can enjoy ONE|GT to the fullest. There will also be a private residents' pool, full gym, and separate residents' entrance, along with onsite covered and valet parking and owner storage units available. Owners will also enjoy very solid returns on investment from ONE|GT's rental programs or can choose to rent their units on the open market. Estimated completion date is early 2025. Enjoy truly "elevated modern island living" at ONE|GT and invest now before prices elevate too! Unit Type F This four-bedroom, split-level loft penthouse is the crown jewel in ONE | GT's collection of residences. With just two units in the whole property, it is ONE|GT's most exclusive offering and enjoys stunning direct ocean views from both of its floors. Each floor offers an ensuite master bedroom and the ground floor offer the ultimate in indoor/outdoor living, dining and entertainment. Enjoy truly "elevated modern island living" at ONE|GT and invest now before prices elevate too!

### PROPERTY FEATURES

Views	Water View, Inland
Block	14BH
Parcel	167UNIT902
Foundation	Slab

### PRESENTED BY



**Bettina Baldwin**  
+1-345-916-7766  
bettina@paradisepropertiescayman.com

IMAGES

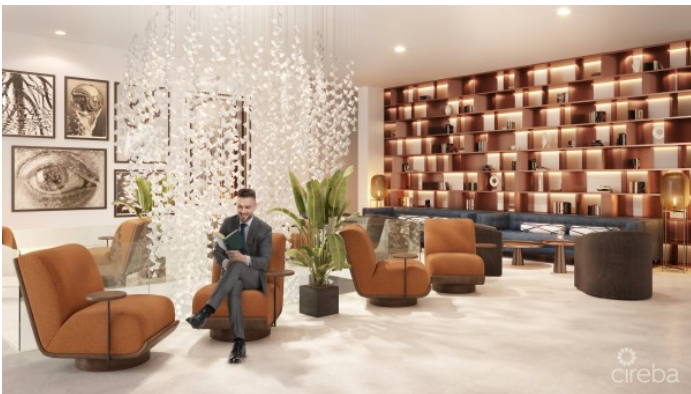



ONE|GT



UNIT TYPE 9  
Lower Floor

BEDROOMS:	2
BATHROOMS:	2
DEH:	YES
INTERNAL SQ FT:	1,454
EXTERNAL SQ FT:	712
TOTAL SQ FT:	2,366

Must be signed, stamped and sealed by a registered professional architect, engineer, planner, interior designer, landscape architect or other qualified professional to be used for construction purposes.

ONE|GT



UNIT TYPE 8  
Upper Floor

BEDROOMS:	2
BATHROOMS:	2
DEN:	YES
INTERNAL SQ FT:	1,654
EXTERNAL SQ FT:	712
TOTAL SQ FT:	2,366

Not to scale. Plans are illustrative purposes only and should not be used for construction without the approval of the relevant authority. All dimensions are approximate and subject to change without notice.

